

## How to place your signature above the quoted text (below your reply)

[Follow](#)

By default, Postbox will place your signature below the quoted text, but you can make it place your signature above the quote. There is a separate setting for each account and identity, where you can configure where your signature is placed.

1. In the folder pane, right-click on the account name and select **Settings**.
2. Select the **Composition** panel for that account.
3. Set *and place my signature* to **below my reply (above the quote)**.

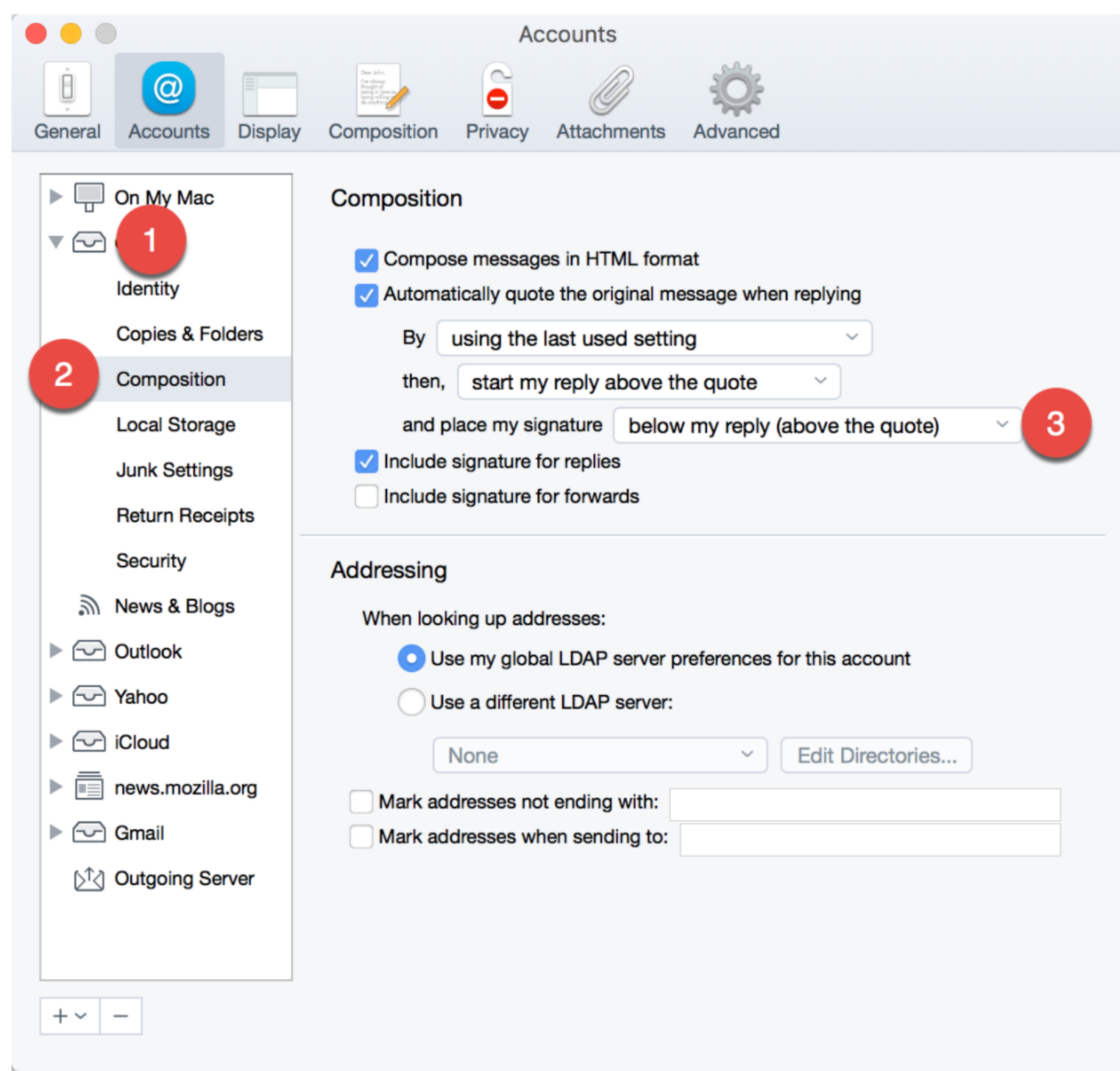

### Recently viewed articles

- [Composing a message](#)
- [Postbox BETA 6 Release](#)
- [How to Troubleshoot and Prevent Crashes](#)
- [Yahoo Error: "RETR command did not succeed"](#)
- [Error Message: www.postbox-inc could not be found](#)

### Related articles

- [Signatures](#)
- [How to remove "--" signature delimiter](#)
- [Advanced Styling for Signatures](#)
- [Troubleshooting Signatures](#)
- [Postbox Keyboard Shortcuts](#)

### Related Articles

- [Signatures](#)
- [Signatures Add-on](#)
- [Removing the "--" before signatures](#)
- [Advanced Styling for Signatures](#)
- [Troubleshooting Signatures](#)



Be the first to hear about our news and offers.